

Portable Strain Gage Welding and Soldering Unit



FEATURES

- Separate visual and audible indicators monitor welder status — Weld energy is continuously adjustable from 3 to 50 joules, making the Model 700 an excellent choice for installing weldable strain gages and temperature sensors, as well as small thermocouples and light-gauge metal.
- Supplied with a lightweight soldering pencil — A front-panel control adjusts soldering tip temperature for a wide range of soldering applications in the field or in the laboratory.
- “Low-battery” light to warn the user when the internal, sealed lead-acid battery requires charging — A battery charger is included to provide for full battery charge with no danger of overcharging. Indicator lights monitor battery charge rate.
- Convenient storage space for cables, battery charger and instruction manual.

GENERAL SPECIFICATIONS

Overall Size:

9 L x 9 W x 9-3/4 H in [230 x 230 x 250 mm].

Weight:

21 lb [9.5 kg].

Power for Recharging:

115 Vac or 230 Vac, 50-60 Hz. Uses external AC transformer (provided).

Operating and Storage Temperature Range:

0° to +120°F [-20° to +50°C].

WELDING SPECIFICATIONS

Weld Energy Range:

3 to 50 joules, continuously adjustable by front-panel control. Maximum open-circuit voltage less than 25 Vdc.

Maximum Weld Repetition Rate:

20 per minute at 30 joules, typical.

Number of Welds per Battery Charge:

Approximately 2000 at weld energy setting of 30 joules. This is equivalent to 40 Micro-Measurements weldable gage installations.

Battery Charge Time: (from full discharge)

12 hours to 75% full charge; 18 hours to full charge.

Battery:

One sealed, rechargeable lead-acid (non-liquid) type, 12 volt, 5 ampere-hour.

Welding Probe:

Manually fired with trigger control and “steady-rest.”

Welding Cables:

Two 5 ft [1.5 m], fully flexible.

Weld Energy Monitor:

Calibrated front-panel control with READY and WAIT indicators; audible indication selectable.

Portable Strain Gage Welding and Soldering Unit

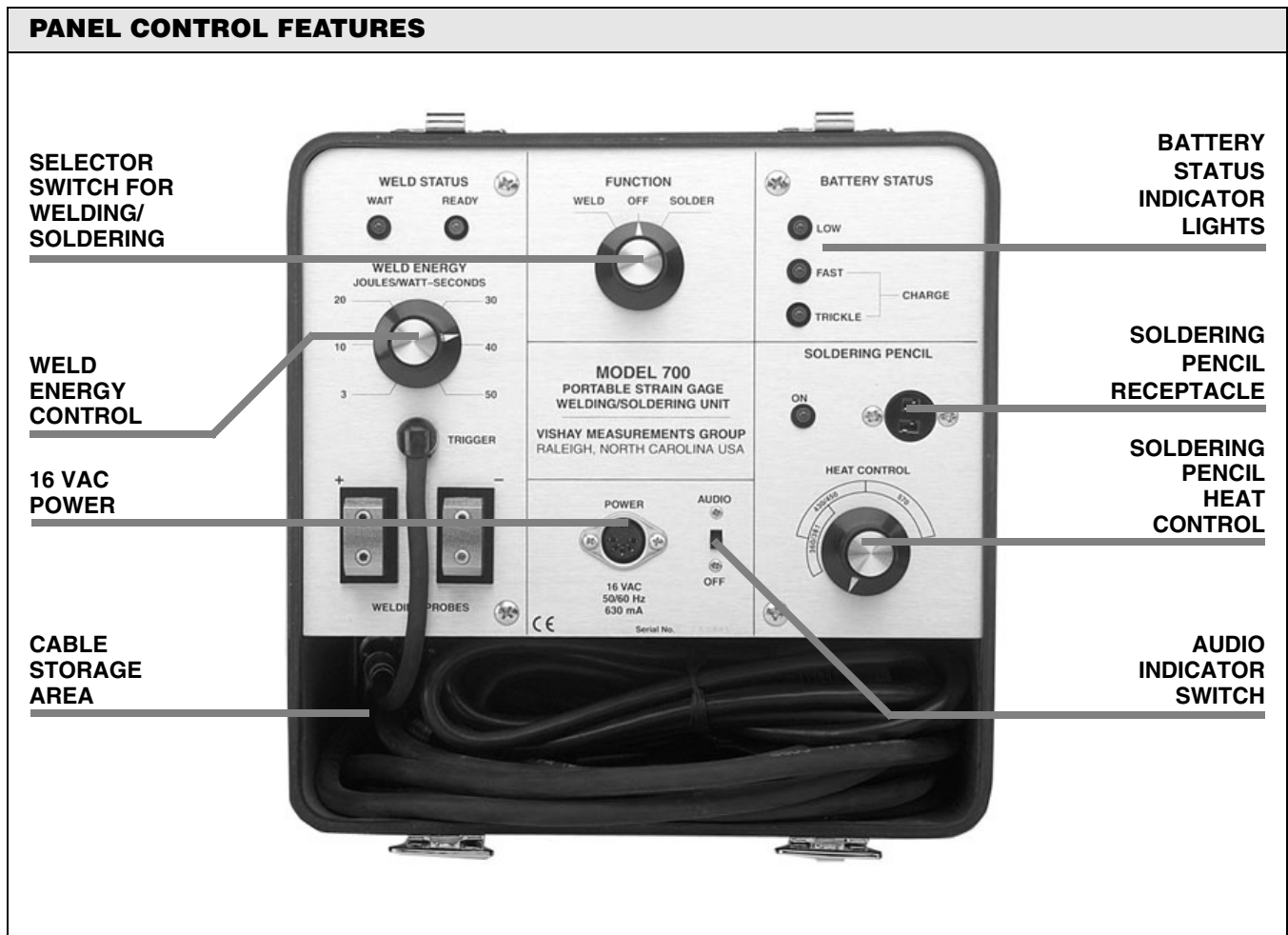
SOLDERING SPECIFICATIONS
Temperature Control:

Continuously variable with bands indicating melting range of solders.

Soldering Pencil:

1.1 oz [31 gm], rated at 25 watts, 12 volt operation. Tip temperature adjustable from +200° to +900°F [+90° to +480°C].

Soldering Duration:

4 hours using +361°F [+183°C] melting point solders (with initial full charge).

Accessory:
Model 700-A103 Spot Welding Probe Set:

Recommended for spot welding instrument leadwires to ZC-Series high-temperature gage ribbons.

All specifications are nominal or typical at +23°C unless noted.